

RIG 14



Primary Equipment



Major Systems	Secondary Systems
Drawworks Continental Emsco D-3 Type II 1,000HP Low Low rated 525,00# single line pull Hoisting Capacity (10) lines Driven by (2) GE 752 DC motors	Wichita Air acuated/water-cooled 236 disc brake
Prime Power Omron/ SCR System, 3 Generator Bays, 3 SCR Bays 3-Caterpillar 3512B w/ Kato 1365 KW AC Gen Sets	1-1/4" WireRope 6 x 19 EIP IWRC
Mast/Substructure IDS 142' 750,000# Hook load with 20' Box type with 25' Box on Box type Crown Block 6-52" Sheaves 1-1/4" Groove Fastline 1-60" 1-1/4" Grooved Walking Systems	Cold Start air system, primary Rig Air supply, floor hoisting systems
Top Drive - Traveling Block - Pipe Handling NOV TDS 11SA VF AC 500Ton Gardner Denver 400 Ton Block SJPetro 27 1/2" Rotary /Drwks Driven Varco ST- 80 Iron Roughneck	Fuel Capacity 18,000gal & Water Storage Capacity 500bbl
IAT rotating MH	Rotary load 750,000# Set Back 450,000#
Mud Pumps 2 -Continental Emsco FD-1600 1600HP Triplex 5,000#WP PSI Fluid Ends and delivery system Driven by (2) GE 752 DC motors	Tool Pusher and Crew quarters rig matting boards
Mud System 2 - Tank system (1,200bbl Capacity) w 100bbl TT 2 - National 285P Linear Motion Shale Shakers	Martin-Decker Type E, Pump SPM & PSI, Top Drive control, SCR system controls & MU/BO Torque
BOP Stack Description 11" 5,000#WP Annular 11"5,000#WP Double Ram	Manual Tongs, elevators, slips and clamps for Latshaw supplied DS
Drill String 8 " and 6-1/2" Drill Collars 5" Drill Pipe	Church Energy 3,000PSI Accumulator, 180 gal, 6 station w/remote
	7-NOV Max2000 10HP Mud agitators
	NOV Brandt Desander 3- 10" Cones w/6 x 8 Centrifugal driven by 100HP Motor
	NOV DeSilter 20-4" Cones w/ 6 x 8 Centrifugal driven by 100HP Mtr
	Cameron Type FC 3 1/16"5,000#WP x 2 1/16" 5,000#WP Choke Manifold
	NOV Brandt D-1000-C Degasser
	5" 19.5# G-105 and S-135
	Heavy weight Drill pipe

Annular

11" 5,000#WP

Double Ram

11" 5,000#WP Pipe

11" 5,000#WP Blind

With required adaptors

Mud Cross 11" 5,000#WP

Wing Valve 4 1/16" 5,000#WP

HCR Valve 4 1/16" 5,000#WP

2-Kill Valves 2 1/16" 5,000#WP

Check Valve 2 1/16" 5,000#WP

Choke Line 4 1/16" 5M Armored

Kill Line 2 1/16" 5M Armored

RIG 14

Latshaw
DRILLING™

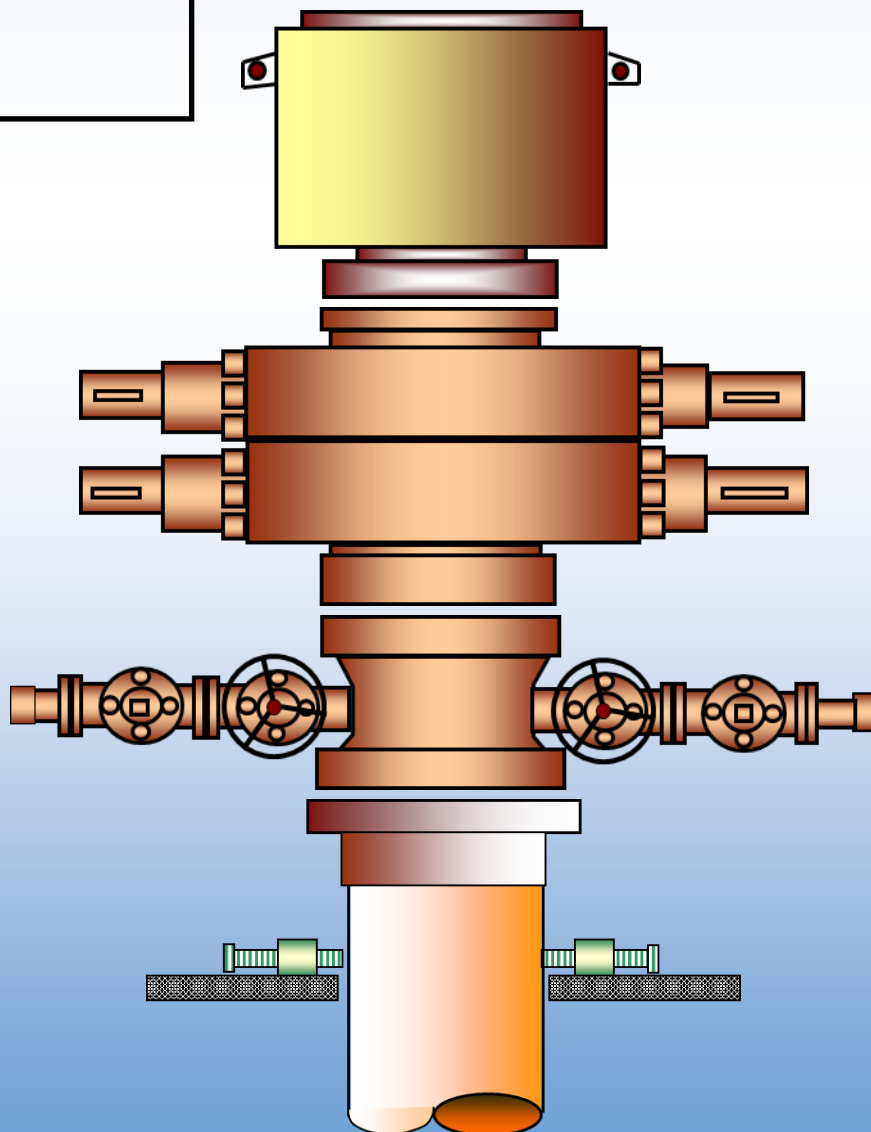

RIG 14

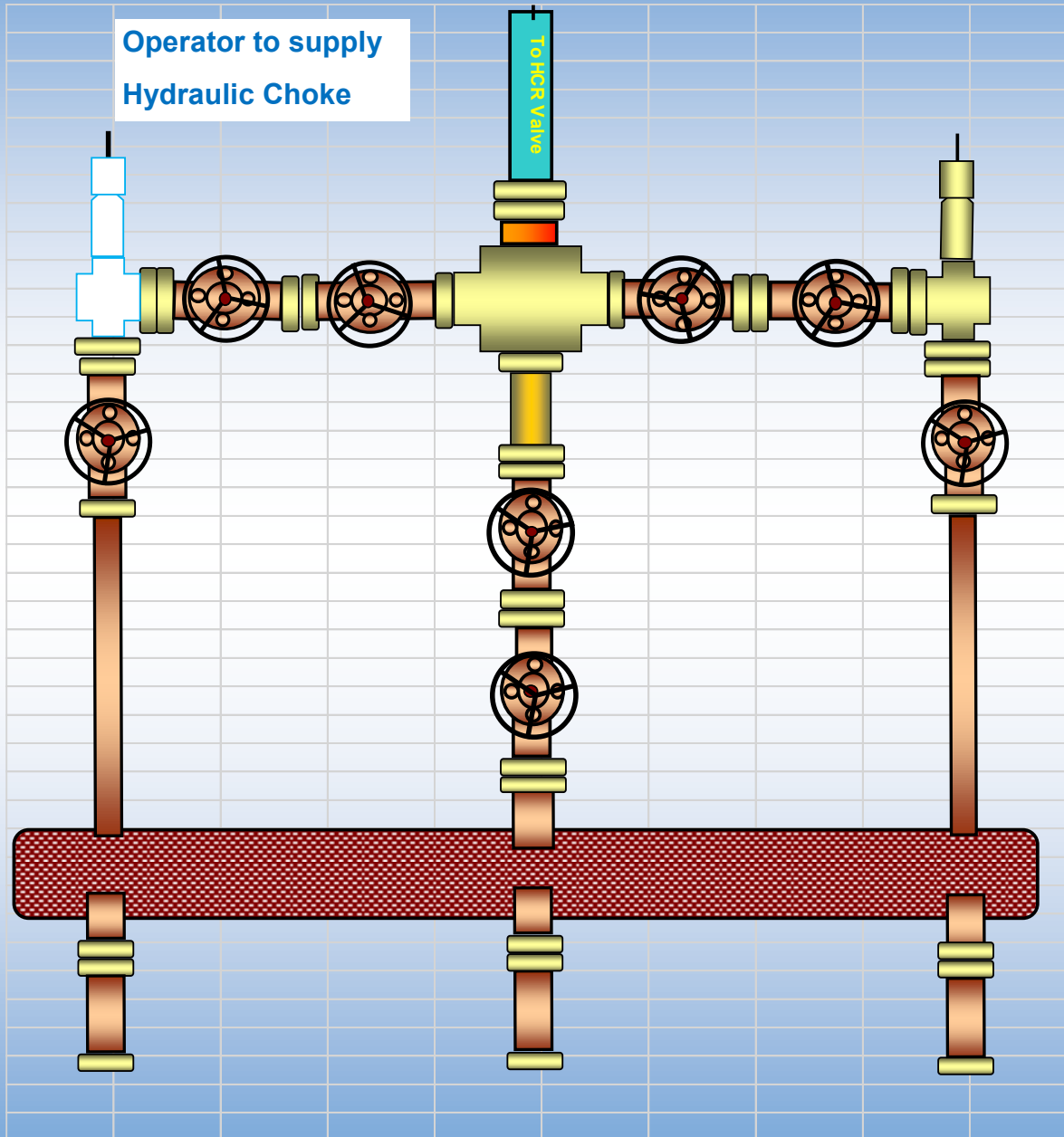

- 1 - Gate Valve 4 1/16" 5,000#WP
- 1 - Gate Valve 4 1/16" 5,000#WP
- 7 - Gate Valves 2 1/16" 5,000#WP
- 4 - Ball Valve 4" 5,000#WP
- 1 - Manual Adjustable Choke 2" 5,000#WP
- 1 - Positive Choke 2" 5,000#WP
- 12" Buffer Chamber
- 5 - 4" Pipe S/80
- 5 - 4" Union 2,000#
- 4 - 2" Pipe S/80
- 4 - 2" Union 2,000#
- 1 - Studded Cross (5way) 4 1/16" x 2 1/16" 5M

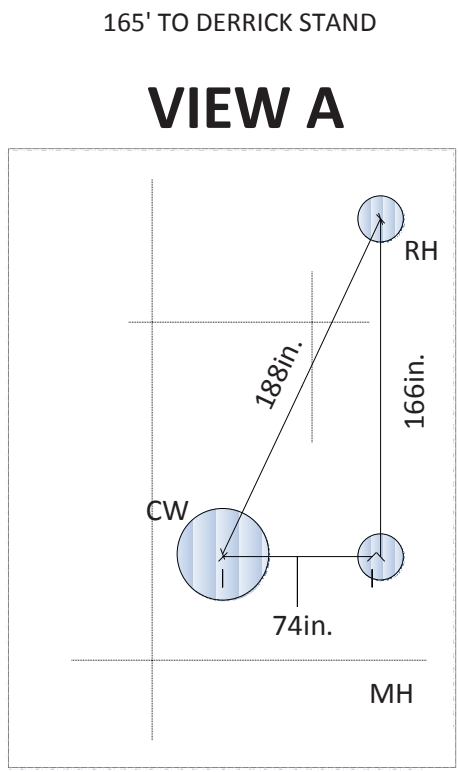
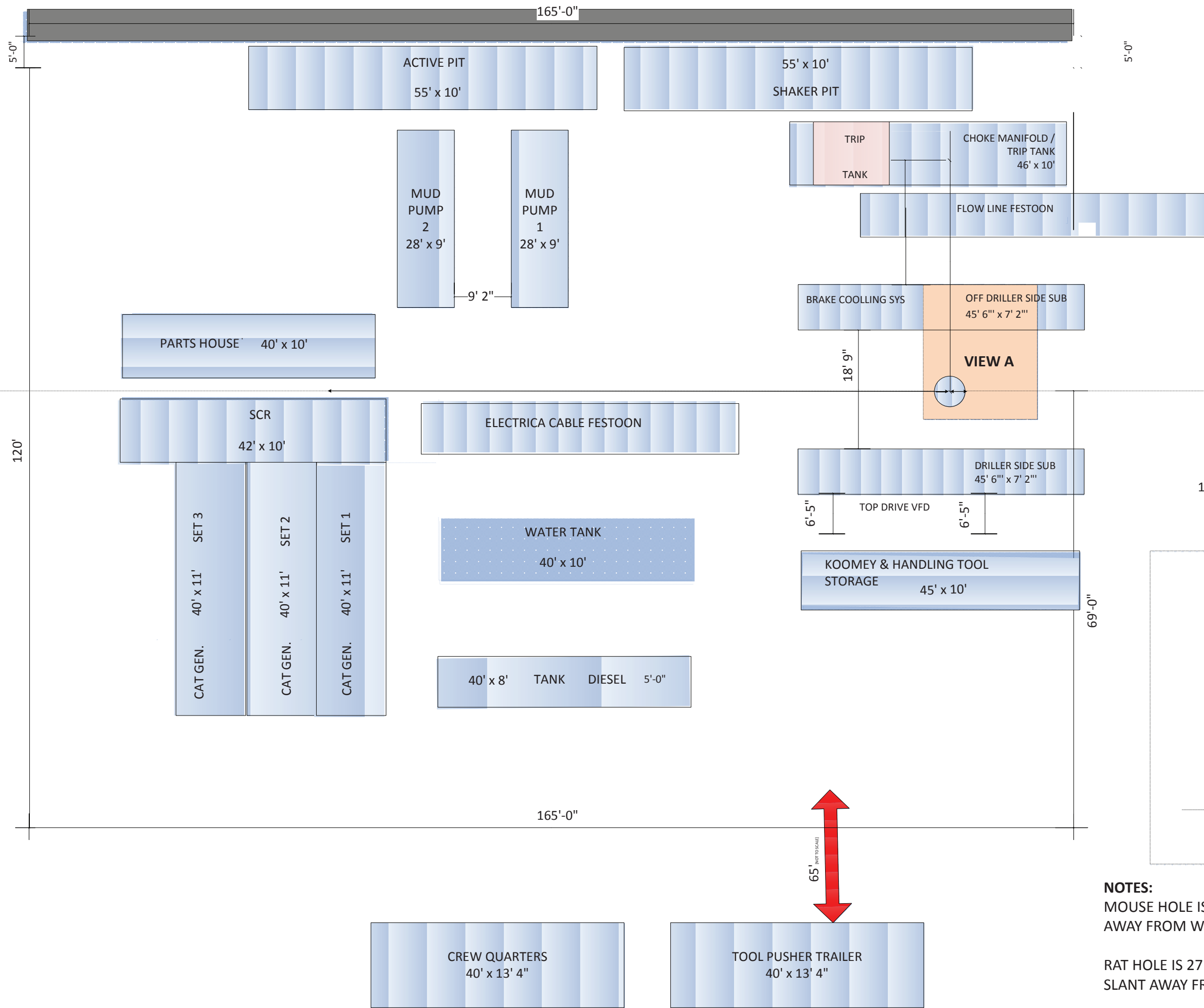

NOTES:
 MOUSE HOLE IS AT A 5 DEGREE SLANT AWAY FROM WELL.
 RAT HOLE IS 27 FEET DEEP AT 10 DEGREE SLANT AWAY FROM WELL

